

# Dome Lights

## LAV series

Refer to our website for product details.

CCS LAV

Search



You can also use your smartphone or cell phone.

Use a search engine.

Provides diffused light evenly using a mechanism that combines a diffused lighting and a coaxial lighting



### Applications

Faulty plating inspection, inspection of a sealed target, inspection for foreign material attached to a glossy surface, character recognition and text inspection for glossy surfaces, and dimension measuring for electronic parts, etc.

### Characteristics

This Light Unit combines diffused lighting and a coaxial lighting. It can evenly perform uniform illumination for glossy, curved workpieces.

#### Example configuration (LAV-80)

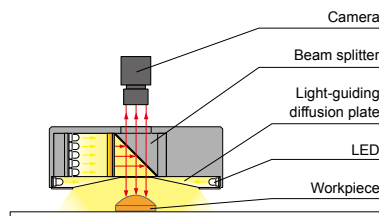

#### Imaging example: Exterior imaging of a connector pin



Workpiece: Connector pin

We accept custom orders. Please feel free to inquire.

- Change to format
- Increase brightness
- Change to wavelength, etc.

#### LED Ring Light



It is difficult to illuminate the whole thing evenly to form an image of the exterior.

#### LAV-80RD2



It is possible to illuminate the whole thing evenly to form an image of the exterior.

### Lineup

Model name	LED color	Power consumption	Peak wavelength/ correlated color temperature	Options	Recommended Control Units	Weight
LAV-80RD2	Red	24 V / 3.6 W	630 nm	-	PD3 PTU2	190 g
LAV-80SW2	White	24 V / 5.0 W	5,500 K			
LAV-80BL2	Blue		470 nm			
LAV-80GR2	Green		525 nm			

\* Use a 2-channel Control Unit.

LED Properties: Light Spectrum ▶ P.208

Extension Cables ▶ P.196

Control Unit Selection Guide ▶ P.155

Control Unit Page ▶ P.159

### Dimensions (mm)

#### LAV-80RD2/SW2/BL2/GR2

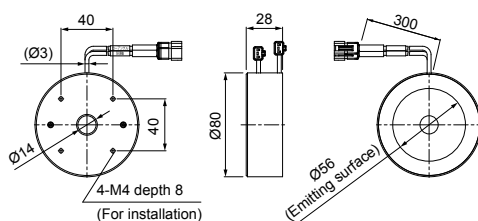

\* The emitting surface for the LAV-80SW2 / BL2 / GR2 is Ø54.

Illumination part	Power consumption
Coaxial illumination part	Red: 1.0 W White/Blue/Green: 1.6 W
Diffused illumination part	Red: 2.6 W White/Blue/Green: 3.4 W

If adjusting the intensity for each part separately, use a 2-channel Control Unit.

You can change the connectors of the LightUnit cable. Choose between M12 connectors and flying leads. Refer to P.115 for details.

We have various materials.

PDF Drawings

DXF Drawings

3D CAD

Instruction Guides

Product Filers

Imaging Samples

Data Sheets

Examples of Custom Ordered Products

Download here.

<http://www.ccs-grp.com/dl/>

# Dome Lights

## PDM series

Refer to our website for product details.

CCS PDM

Search



You can also use your smartphone or cell phone.

Use a search engine.

Diffused Lighting

Dome Lights

PDM series

Provides diffused light evenly using a mechanism that combines a diffused lighting, coaxial lighting, and low-angle lighting



### Applications

Faulty plating inspection, inspection of a sealed target, inspection for foreign material attached to a glossy surface, character recognition and text inspection for glossy surfaces, and dimension measuring for electronic parts, etc.

### Characteristics

This Light Unit combines the three types: dome lighting, low-angle lighting, and coaxial lighting. It illuminates the workpiece with uniform diffused light.

#### Example configuration (PDM-150-15)

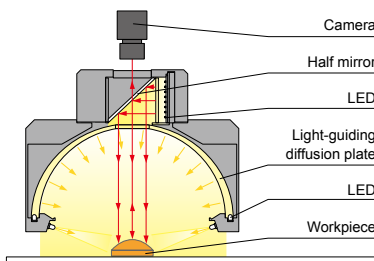

#### Imaging example: 2-D code imaging



Workpiece:  
Contact lens package

We accept custom orders.  
Please feel free to inquire.

- Change to format
- Increase brightness
- Change to wavelength, etc.

#### LED Ring Light



It is difficult to determine the 2-D code due to the glossy and wavy surface.

#### PDM-150-15RD2



It is possible to determine the 2-D code by evenly illuminating the surface.

### Lineup

Model name	LED color	Power consumption	Peak wavelength/ correlated color temperature	Options	Recommended Control Unit	Weight
PDM-150-15RD2	Red	24 V / 18 W	630 nm	-	PD3	1,140 g
PDM-150-15SW2	White	24 V / 22 W	5,500 K			1,170 g
PDM-150-15BL2	Blue		470 nm			1,140 g
PDM-150-15GR2	Green		525 nm			

\* Use a 3-channel Control Unit.

LED Properties: Light Spectrum ▶ P.208

Extension Cables ▶ P.196

Control Unit Selection Guide ▶ P.155

Control Unit Page ▶ P.159

### Dimensions (mm)

PDM-150-15RD2/SW2/BL2/GR2

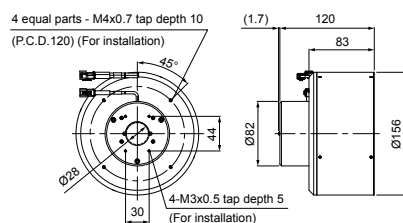

Illumination part	Power consumption
Coaxial illumination part	Red: 3.1 W, White: 2.2 W, Blue/Green: 2.7 W
Dome illumination part	Red: 10.2 W, White: 14 W, Blue/Green: 13 W
Low-angle illumination part	Red: 4.6 W, White/Blue/Green: 6.1 W

If adjusting the intensity for each part separately, use a 3-channel Control Unit.

You can change the connectors of the LightUnit cable. Choose between M12 connectors and flying leads. Refer to P.115 for details.

You can inquire using our website.

Requests for Light Unit Selection

Requests for Demo Products

Requests for Estimates

Requests for a Catalog

Product Inquiries

Other Inquiries

Inquire on our website here.  
<http://www.ccs-grp.com/contact/>

LDR2  
LDR2-LA  
LDR-LA1  
SQR  
SQR-TP  
HLDR-IP  
HPR2  
HPR  
LFR  
LKR  
FPR  
FPQ2  
LDL2  
HLDL2  
TH  
LFL  
HPD2  
HPD  
LDM2  
LAV  
PDM  
LFX2  
LFV3  
LFV2/LFV  
MSU  
MFU  
UV2  
UV  
LNSP-UV-FN  
IR  
HLV2  
LV  
LSP  
HFS/HFR  
HLV2-NR  
HLV2-3M- RGB-3W  
PFB2  
PFBR  
LNSP  
CU-LNSP  
LNSP-FN  
LN/LN-HK  
LND2  
HLND  
LT  
LNV  
Telecentric Lens  
Macro Lens